

THE ELMDALE



FEATURES

- 3 Bedrooms
- 2 Car garage
- Covered front porch
- Cathedral ceiling in great room
- Laundry room on main level
- Fireplace in great room
- Hardwood flooring in kitchen, dining room, and great room
- Maple cabinets
- Ceramic tile in both bathrooms
- Six panel doors throughout the house
- Brick work on exterior
- Maintenance free exterior
- 2 x 6 exterior walls
- High efficiency furnace

CHARMING COUNTRY HOME! A neighborly porch as friendly as a handshake warmly greets family and friends alike. Inside, cathedral ceilings promote a feeling of spaciousness. To the left of the entry way, the great room and dining room are enhanced with a large fireplace, and bump-out for a china cabinet. The open design makes the space feel even bigger. The master bedroom with its private bath and walk-in closet are located at the front of the house. The two additional bedrooms, one with a walk-in closet, share a second full bathroom.

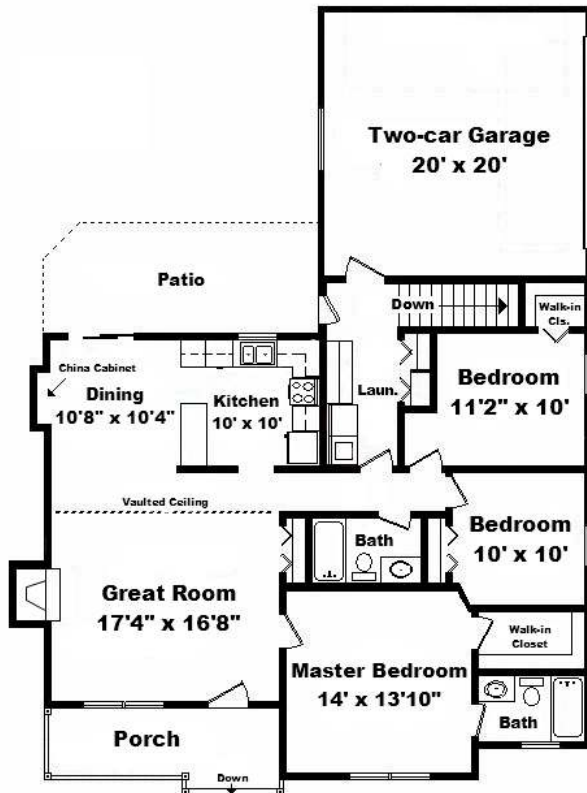

Base Price \$ _____



GENERAL CONTRACTOR • NEW HOMES
REMODELING

P.O. Box 338 • Fredonia, WI 53021
920-994-8101
www.championshipbuilders.com

"HELPING WISCONSIN FAMILIES BUILD THEIR DREAMS FOR OVER 15 YEARS"